

DP3613

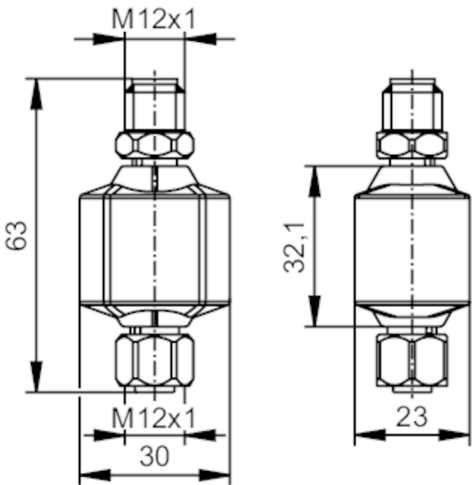

Relay adapter

RELAIS ADAPTER/2xNC/IP69K



Product characteristics		
Output function		normally closed
Dimensions	[mm]	63 x 30 x 23
Electrical data		
Operating voltage	[V]	18...30 DC; ((in wet environments: 18...28 V) ; to SELV/PELV)
Nominal voltage DC	[V]	24
Current consumption	[mA]	< 10
Nass		
Operating voltage	[V]	18...28 DC
Inputs / outputs		
Number of inputs and outputs		Number of digital inputs: 2; Number of relay outputs: 2
Inputs		
Number of digital inputs		2; (type 3 (IEC 61131-2))
Outputs		
Voltage range DC	[V]	0...32; (to SELV/PELV)
Voltage range AC	[V]	0...20; ((in wet environments: 0...16 V); to SELV/PELV)
Output function		normally closed
Max. current load per output	[mA]	1000; (socket pin 1: 2000 mA)
Number of relay outputs		2
Switching frequency AC	[Hz]	1
Switching frequency DC	[Hz]	1
Notes on switching frequency	[Hz]	no capacitive loads
Operating conditions		
Ambient temperature	[°C]	-25...60
Note on ambient temperature		2000 m: -25...60 °C
		3000 m: -25...55 °C
		4000 m: -25...52 °C
Storage temperature	[°C]	-25...70

DP3613



Relay adapter

RELAIS ADAPTER/2xNC/IP69K

Max. relative air humidity	[%]	90; (linearly decreasing to 50 % (40 °C) non condensing)
Max. height above sea level	[m]	4000
Protection		IP 67; IP 69K
Pollution degree		2; (before installation and when the device is replaced)

Tests / approvals

MTTF	[years]	942
------	---------	-----

Mechanical data

Weight	[g]	75.3
Weight (without accessories and packaging)	[g]	35
Dimensions	[mm]	63 x 30 x 23
Materials		housing: PA; threaded sleeve: stainless steel (316L/1.4404)
Sealing material		FKM

Remarks

Remarks	For further information please see the operating instructions.
Pack quantity	1 pcs.

Electrical connection - plug

Connector: 1 x M12, straight; coding: A; Sealing: FKM

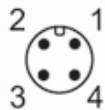

- 1: L+
2: IN1 DI
3: L-
4: IN2 DI

Electrical connection - socket

Connector: 1 x M12, straight; coding: A; Sealing: FKM

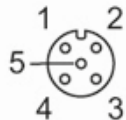

- 1: L1 / L+ (AC/DC)
2: OUT1 NC
3: n.c.
4: OUT2 NC
5: n.c.